

	As.	Ps.
W <sup>m</sup> Roswell	184.	153
John Negus	107.	81
Stephen Negus	132.	153
	<u>425.</u>	<u>48</u>

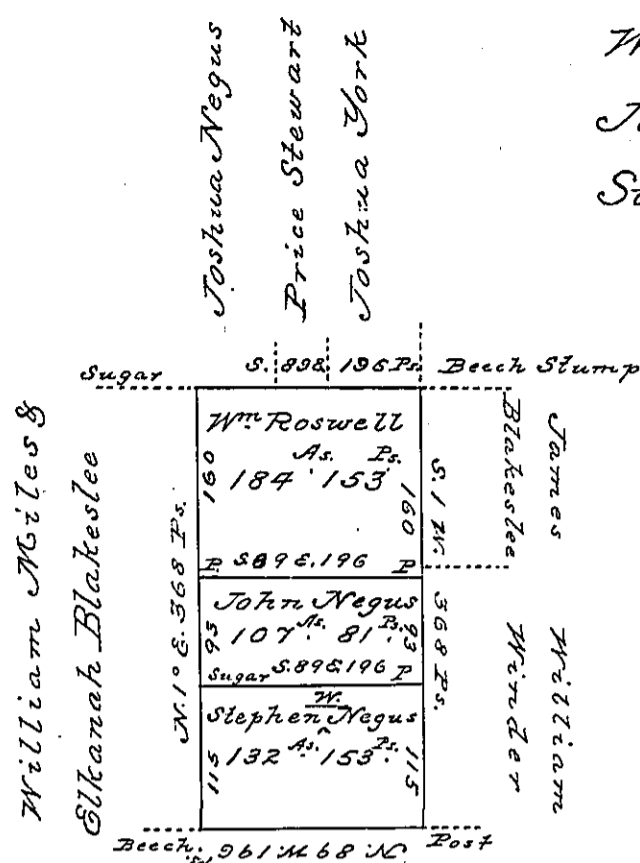

Eight donation District

In pursuance of the Settlement of Shadlock Negus begun about the 1800, was Surveyed on the 20<sup>th</sup> day of October 1837 the above described tract of land containing 425 Acres 48 perches and allowance of six per cent for roads &c. situate in Bloomfield Township Crawford county (The North 184 acres 153 perches having been surveyed for William Roswell The middle 107 acres 81 perches for John Negus, and the South 132 acres 153 perches for Stephen Negus, agreeably to the above plot)

John Taylor Esqr. S. Gen. }  
Eben<sup>r</sup> Felton D. S.

I hereby certify that it does not appear from the Books or Documents <sup>in my office</sup> that the above described land has been otherwise appropriated by warrant or otherwise

Eben<sup>r</sup> Felton D. S.

IN TESTIMONY that the above is a copy of the original remaining on file in the Department of Internal Affairs of Pennsylvania, made conformably to an Act of Assembly approved the 16th day of February, 1833, I have hereunto set my Hand and caused the Seal of said Department to be affixed at Harrisburg, this

Third day of November 1896

James W. Fitter  
Secretary of Internal Affairs.